

Webstone's Lead Free Pro-Connect™ ProPush Products are both quick to install and easy to remove.

Lead-Free Pro-Connect™ ProPush Products conform to ASSE 1061, NSF/ANSI 61-G and are cUPC listed for use with PEX (ASTM F876, CSA B137.5), Copper (ASTM B88) and CPVC (ASTM D2846, CAS B137.6) tubing.

Installing Tubing into Pro-Connect™ ProPush Products

STEP 1: CUT

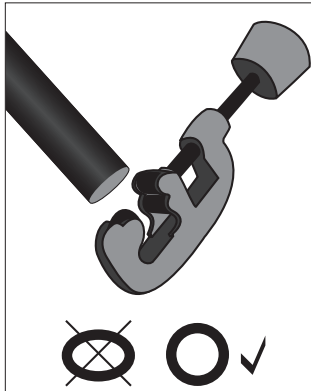

STEP 2: DEBURR

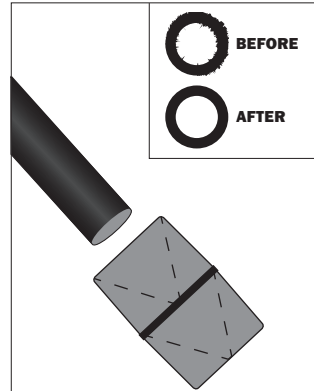

STEP 3: MEASURE

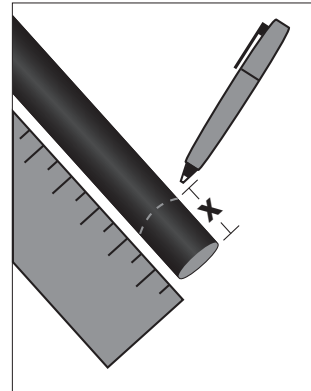

STEP 4: INSTALL TO LINE

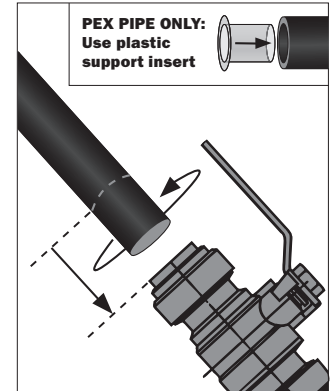

The installer must ensure that any installation complies with all local plumbing and building codes.

Step 1 – Match Tubing and Valve Size, Cut Tubing

Match the tubing size with the appropriate Pro-Connect™ ProPush Product. Verify that both the tubing and Pro-Connect™ ProPush product are clean, undamaged and appropriate for the intended service. Cut the tubing to the proper length necessary for the installation.

IMPORTANT: The tubing must be long enough to fit inside the Pro-Connect™ ProPush product, not just to reach its face.

The approximate depth that the tubing will be inserted is shown in the table to the right.

When cutting the tubing, care must be exercised to ensure the end is flat, the tubing remains round and does not get flattened into an oval. Failure to do so may affect the performance of the joint.

PRODUCT SIZE	INSERTION DEPTH
1/4"	1/2"
3/8"	7/8"
1/2"	15/16"
3/4"	1 1/8"
1"	1 1/4"
1 1/4"	1 3/8"
1 1/2"	1 5/8"
2"	1 7/8"

Step 2 – Deburr Tubing

Both inside and outside of the tubing must be cleaned of burrs prior to installation. Failure to properly deburr the interior and exterior of the tubing may result in damage to the product's O-ring.

Step 3 – Measure Tubing Insertion Depth

Prior to installing the tubing into the Pro-Connect™ ProPush product, measure the approximate insertion depth from the end of the line and mark it with felt tipped pen.

Step 4 – Installing to Line

If PEX tubing is used, the plastic support piece must be installed into the tubing to ensure that it retains its rigidity.

The plastic support piece is not required and should not be utilized for installations with copper pipe or CPVC tubing.

Insert the tubing into the Pro-Connect™ ProPush product and slowly turn the tube and/or product to facilitate moving the tube past the product's O-Ring seal. Water may be used as a lubricant if desired, HOWEVER NO OTHER LUBRICANTS MAY BE USED. The tubing has been fully inserted into the valve when the line drawn in Step 3 reaches the edge of the fitting.

Once all of the connections have been completed, and it is safe to do so, the piping system must be checked for leaks.

Product installer must provide protection against abrasion where the Pro-Connect™ ProPush fittings or valves are in contact with other building materials. If installing Pro-Connect™ ProPush fittings or valves underground, the fittings and/or valves must be tightly wrapped and sealed with an impervious material such as chloride free tape to prevent direct contact with groundwater or backfill. Backfill should be free of rocks, debris, sharp objects, or corrosive agents that may cause damage through contact.

Evidence of improper installation, mishandling, accidental damage, freeze or chemical damage or any modifications will void the warranty coverage. It is expressly understood that failure of any Pro-Connect™ ProPush product resulting from any freezing fluids within the pipes does not constitute a defect in material or workmanship and shall not be covered by the warranty.

Pressure test the system for 24 hours before the system is buried or enclosed.

Removing Tubing from Pro-Connect™ ProPush Products

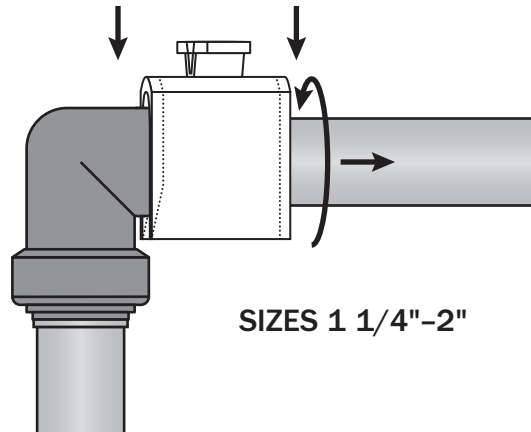
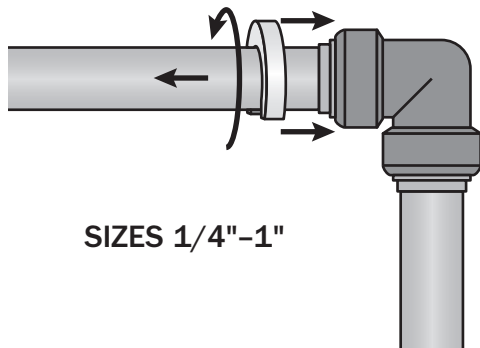

Removing a Pro-Connect™ ProPush product requires the use of the appropriately-sized C-Clip Removal Tool or Large Fitting Removal Tool, provided with Pro-Connect™ ProPush Valves and sold separately for Pro-Connect™ ProPush Fittings.

Step 1 – Depressurize and Drain Tubing

Prior to removing the tubing from the Pro-Connect™ ProPush Product, the plumbing system must be depressurized and drained.

Step 2 – Depress Release Collar

SIZES 1/4"-1": Push the C-Clip Removal Tool on to the tubing, making sure the flat edge of the tool is positioned to contact the release collar. Grip the removal tool and slide it against the release collar. Depress the release collar and simultaneously pull the Pro-Connect™ ProPush and tubing assembly apart using a slight twisting action.

SIZES 1 1/4"-2": Slide the Large Fitting Removal Tool on to the fitting assembly, with the tapered interior groove on the fitting side of the tool. The tapered shape of the tool will compress the push release ring, allowing the Pro-Connect™ ProPush and tubing assembly to be pulled apart using a slight twisting action.

Step 3 – Check for Damage

Inspect the interior of the Pro-Connect™ ProPush connection for any damage.

If the tubing appears to be damaged, or has sharp edges it must be repaired or the damaged section removed prior to reinstalling the Pro-Connect™ ProPush Connection.