

For Residential and Commercial Applications

Job Name		Engineer / Architect	
Job Location		Wholesaler	
Submittal Date		Contractor	

BC7223 Lift & Turn Drain Kit - 1-1/2" IPS Coarse Thread

Use: Replacement drain for use with standard tub & showers

Design Features:

- **Single hole overflow faceplate** provides a clean finish & includes a screw plate
- **Lift & turn stopper** is a low maintenance alternative to antiquated trip lever style drain kit with a reduction in hair collection & no complicated linkage
- **Multiple finishes available** to match most bathroom decor

MATERIAL SPECIFICATIONS	
Drain Body	Plated C36000 brass
Washer	EPDM rubber
Stopper	Plated brass
Faceplate	Plated stainless steel
Screw	Zinc plated steel
Screwplate	Plated stainless steel

PART DIMENSIONS (Inches)				
Model	DIA. A	DIM. B	DIM. C	DIA. D
BC7223	2.70	2.35	.52	3.17

Part Listing:

- ☐ BC7223 BZ Lift & Turn Drain Kit with single-hole faceplate, screw & plate included, 1-1/2" coarse thread, oil rubbed bronze
- ☐ BC7223 NP Lift & Turn Drain Kit with single-hole faceplate, screw & plate included, 1-1/2" coarse thread, polished nickel
- ☐ BC7223 NS Lift & Turn Drain Kit with single-hole faceplate, screw & plate included, 1-1/2" coarse thread, satin nickel
- ☐ BC7223 P Lift & Turn Drain Kit with single-hole faceplate, screw & plate included, 1-1/2" coarse thread, polished brass

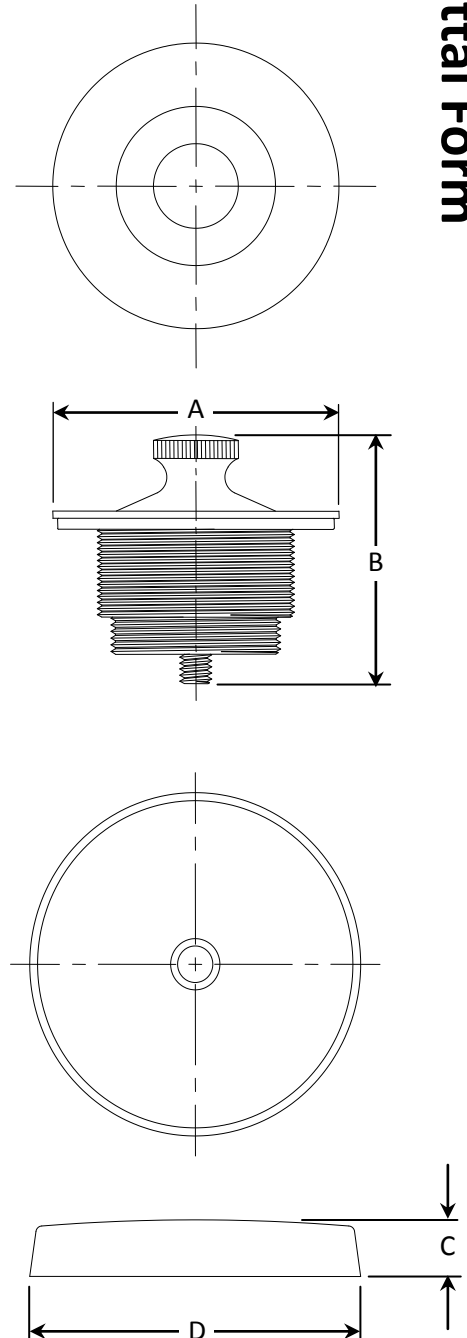

This specification and all information contained herein is the confidential and exclusive property of BrassCraft Manufacturing, and shall not be disclosed to others without the written consent of BrassCraft. This specification must be returned to BrassCraft if requested.

400.300 BC7223 Lift & Turn Drain Kit REV 6/10

BrassCraft

© 2010 Brass-Craft Mfg.