

*Futura*®

## TOWEL RING

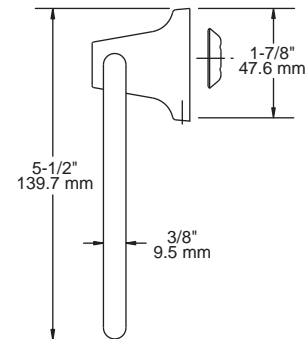
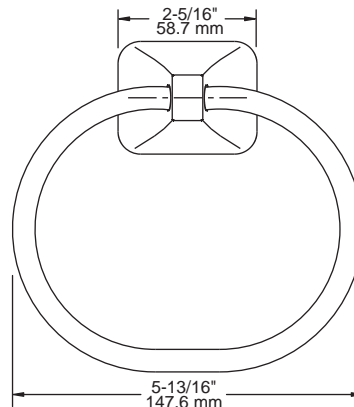

**MATERIALS:**

Post - Zinc Die Cast  
Ring - Aluminum Tubing  
Wall Plate - Steel, Nickel Plated

**INSTALLATION:**

Mount wall plate bracket(s) per installation instructions with supplied fasteners. Slip product over wall plate(s) and tighten set screws until secure.

**OPTIONAL FASTENER INFORMATION:**

Wood blocking is preferable behind all wall surfaces. If wood blocking is not available, the following fasteners are suggested: Tile/Masonry - Plastic or Lead Anchors, Plaster/Drywall - Toggle Bolts

**SPECIFICATION:**

Surface mounted towel ring shall be model \_\_\_\_\_  
(fill in model number) by Liberty Hardware Manufacturing Corporation.

**FranklinBrass**®  
A Liberty Hardware Brand

Liberty Hardware Manufacturing Corporation • 140 Business Park Drive • Winston-Salem, NC 27107 • 800.542.3789 • [www.libertyhardware.com](http://www.libertyhardware.com)

©2009 LHMC, A Masco Company