

# TECHNICAL SPECIFICATIONS

## SP-3448

**MODEL NUMBER 141071**

DIMENSIONS: 48" x 34" x 6" Gelcoat



### STANDARD FEATURES

- Rectangular shower base
- Integrated tiling flange
- Textured floor
- Center drain

### UNIQUE FEATURES

- Tiling Flange

### OPTIONS

- None

### SYSTEMS

- None

### DOOR SELECTION

Combine with AKER's complete shower door offering visit [www.akerbymax.com](http://www.akerbymax.com)

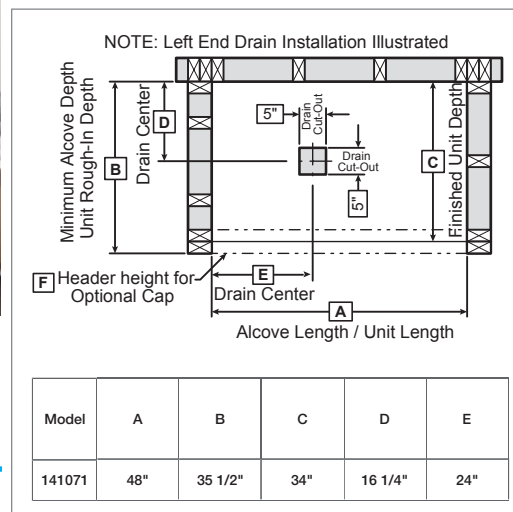

Project : \_\_\_\_\_

Contractor : \_\_\_\_\_

AKER Representative : \_\_\_\_\_ Tel : \_\_\_\_\_

Date : \_\_\_\_\_

### CERTIFICATIONS

AKER products adhere to one or more of the following certifications:



## TECHNICAL SPECIFICATIONS

# SP-3448

MODEL NUMBER 141071

## TECHNICAL DRAWINGS

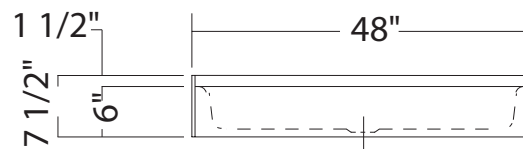
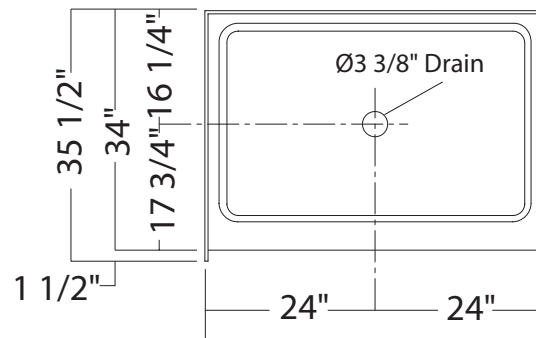

All dimensions are approximate. Structure measurements must be verified against the unit to ensure proper fit.