

Project Name: _____		Approval: _____	
Location: _____		Date: _____	
Engineer: _____		Construction: _____	
Submitted to: _____		Unit #: _____	
Submitted by: _____		Drawing #: _____	
Reference: _____			

MODEL COMPATIBILITY:

Compatible with Single-Zone and Multi-Zone indoor unit models: CDXS, CTXS, FDXS, FTK_N, FTK_A, FTX_N, FTX_A, FTX_U, FTXG*, FTXR, FTXS, FVXS

*The Sarara drying function of the *QUATERNITY* units is not supported with the BRC944.

The following indoor units do not have the S21 connection and require an additional interface adaptor (ordered separately) to provide the S21 connector for the One+ communication:

Indoor Unit Models	Required Interface Adaptor
FTX09NMVJU, FTX12NMVJU, FTK09NMVJU, FTK12NMVJU	KRP067A41E
FTX15NMVJU, FTX18NMVJU, FTX24NMVJU, FTK18NMVJU, FTK24NMVJU	KRP980B2E

SPECIFICATIONS:

Model	BRC944B2-A08
Description	Wired Remote Controller Kit ¹
Maximum Indoor Units	1
Dimensions	4.75 in x 4.75 in x 0.69 in (120mm x 120mm x 17.5 mm)
Communication Protocol	S21
Comfort Setpoint Range	64°F – 90°F Set Point Range
Operation	Start / Stop
	Mode (Auto/Heat/Cool/Dry)
	Set Temperature Setpoint
	Fan Speed
	Airflow Direction
Scheduling	One-time Timer
	Daily Timer

PRODUCT IMAGE:



BRC944B2



BRCW901A08

¹The Wired Remote Controller kit includes a Wired Remote Controller (BRC944B2) and a wired remote controller cable (BRCW901A08)

Project Name: _____	Approval: _____
Location: _____	Date: _____
Engineer: _____	Construction: _____
Submitted to: _____	Unit #: _____
Submitted by: _____	Drawing #: _____
Reference: _____	

FEATURES:

- Selectable auto / cool / heat / dry operation modes with adjustable setpoint and fan speed
- Set temperature setpoint in °F or °C units with 1 degree increments
- Temperature is controlled through indoor unit temperature sensor
- Built in one time or daily timer functionality with up to 2 timer actions per day
- Approximately two-hour battery backup
- Can be used together with the factory supplied standard wireless remote controller
- An additional or replacement wired remote controller cable can be ordered:
 - BRCW901A03: Non-plenum rated, 10ft
 - BRCW901A08: Non-plenum rated, 26ft
 - DACA-BRCW901P10: Plenum rated, 10ft
 - DACA-BRCW901P25: Plenum rated, 25ft

DIMENSIONS:

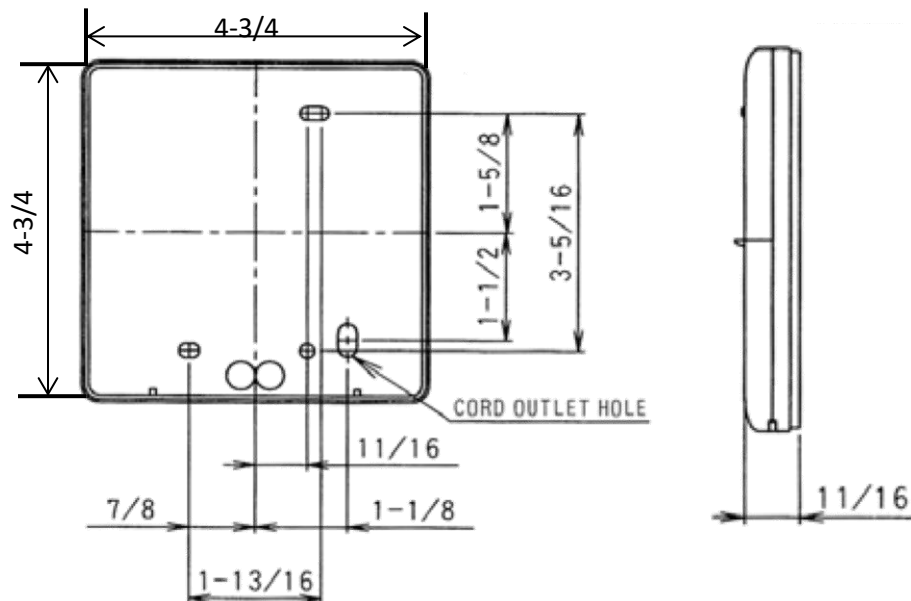

DOCUMENTATION:

Documentation available on www.daikincity.com and/or www.daikinac.com:

- Submittal
- Installation Manual
- Operation Manual

DAIKIN COMFORT TECHNOLOGIES NORTH AMERICA, INC.

19001 Kermier Road | Waller, TX, 77484

www.daikinac.com www.daikincity.com

Rev. 1022

(Daikin's products are subject to continuous improvements. Daikin reserves the right to modify product design, specifications and information in this data sheet without notice and without incurring any obligations)