

**Part No:** CLIC2-012CTS010

**CLIC® TOP & CLIC® Pipe  
Hangers & Spacers**

**CLIC® Original Pipe Hangers**

**Desc:** 1 IPS&1-1/4CTS CLIC LIGHT GRAY PIPE CLAM

**MSRP:** 5.77

**Part Code:** 893

**Weight(lbs):** 0.031

**Weight(kg):** 0.014

**Weight(gm):** 14

**Size:** 1 IPS&1-1/4CTS CLIC LIGHT

**Color:** GRAY

**Material:** Copolymer

**Type** IPS & CTS Pipe Hanger

**Connection** Pipe Clamp

**Note** Not Approved for FlameGuard®  
Pipe

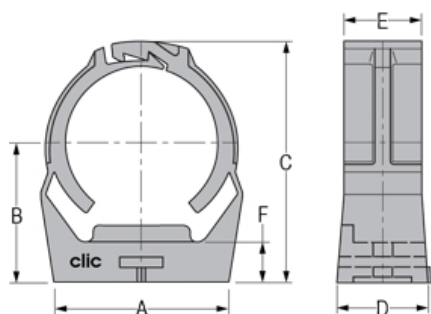

**A** = 1-1/2

**B** = 1-3/8

**C** = 2-5/32

**D** = 27/32

**E** = 11/16

**F** = 3/8

## Injection Molded Dimension References:

**G** = (LAYING LENGTH) intersection of center lines to bottom of socket/thread; 90° elbows, tees, crosses;  $\pm 1/32$  inch.

**H** = Intersection of center lines to face of fitting; 90° elbows tees, crosses;  $\pm 1/32$  inch.

**J** = Intersection of center lines to bottom of socket/thread; 45° elbows;  $\pm 1/32$  inch

**L** = Overall length of fittings;  $\pm 1/16$  inch.

**M** = Outside diameter of socket/thread hub;  $\pm 1/16$  inch.

**N** = Socket bottom to socket bottom; couplings;  $\pm 1/16$  inch.

**W** = Height of cap;  $\pm 1/16$  inch

## Typical Molded Dimension References

