

Model WF1EZ

1500-GALLON CAPACITY EZ DOOR® FILTER

TECHNICAL ASSISTANCE TOLL FREE TELEPHONE NUMBER:

1.800.591.9360

Technical Assistance E-Mail: fieldservice@acorneng.com

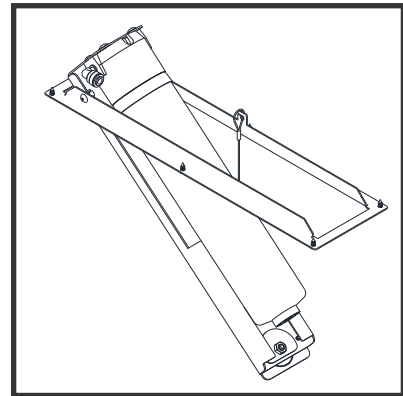

PREPARATION FOR FILTER INSTALLATION

1 For Units With WF1EZ Filter Access:
Remove Housing Skirt Panel [1]. Shut off unit water supply using Shut-Off Valve by Others (**DETAIL A**).

Remove Filter Access Panel [2] and discard. Set aside the Screws for reassembly.

2 Locate Water Supply Line [3] through the opening of the Filter Access Panel. Remove and Discard Push-In Coupler [10] Fitting to insert Filter.

Disconnecting The Push-In Fitting: (DETAIL B) Ensure that the water supply is turned off. Using Fixture Universal Tool, push collet square towards the push-in fitting body and hold. While pushing the collet in, pull on the PE tubing to remove from the push-in fitting. Repeat for opposite side.

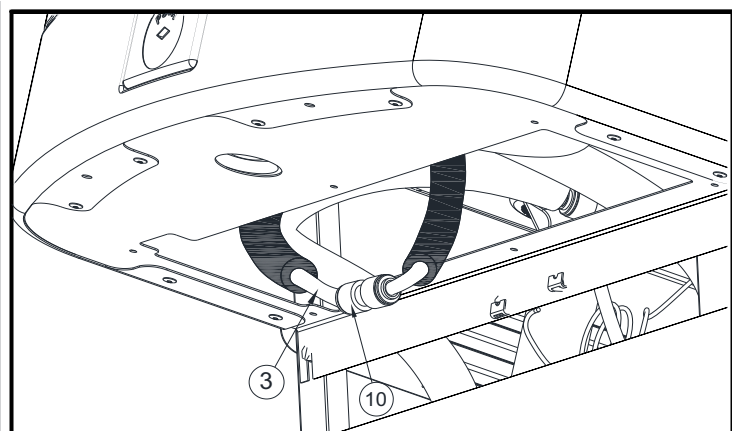
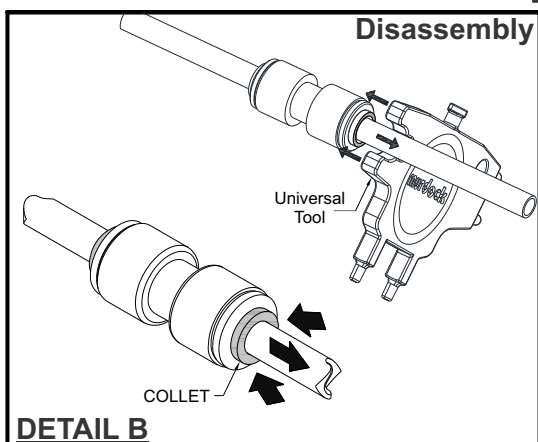
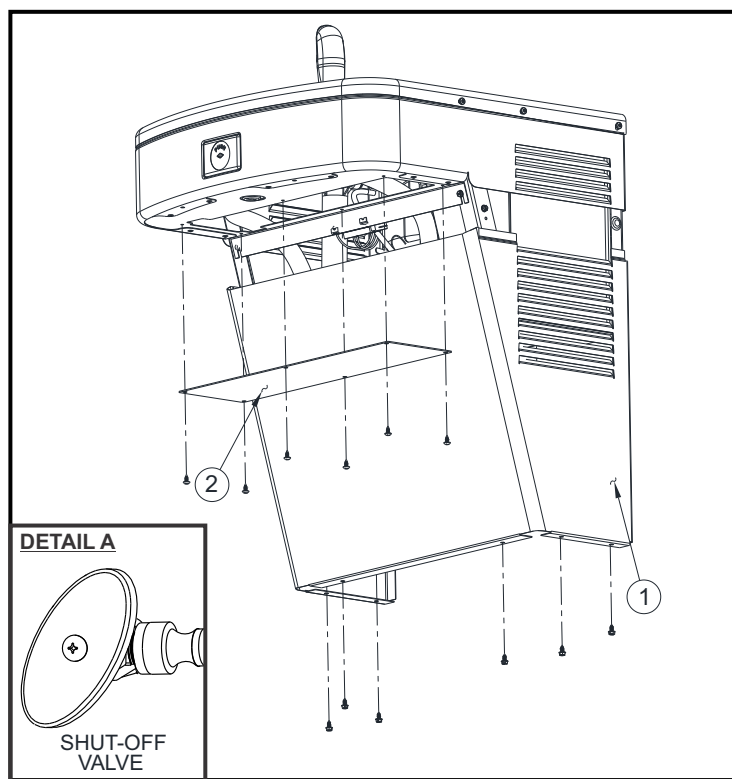

INSTALLING FILTER ASSEMBLY

3 Inserting The Tube: First pressed firmly and fully insert the Inlet from supply line tubing end into the push-in fitting [5] up to the tube stop located approximately 1/2" deep. Gently pull on the fitted tubing to ensure it is secure. **(DETAIL C)** Tube should not come free from the fitting. Water test the connection assembly prior to leaving the site to ensure there are no leaks.



!IMPORTANT
Note: Insert water line on push-in stem with it corresponding flow line.



HINT: Remove Filter Cartridge first for easier installment.

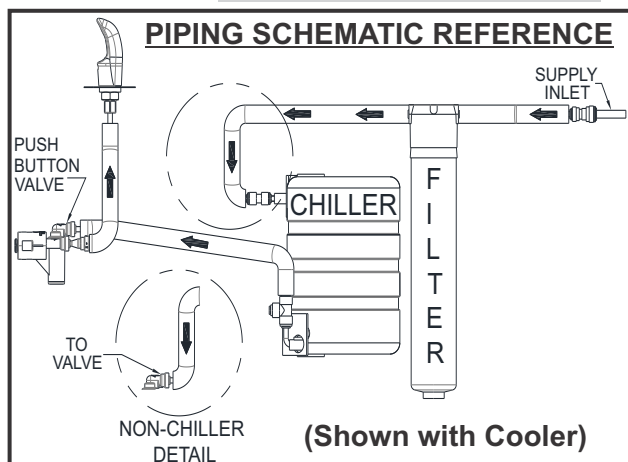
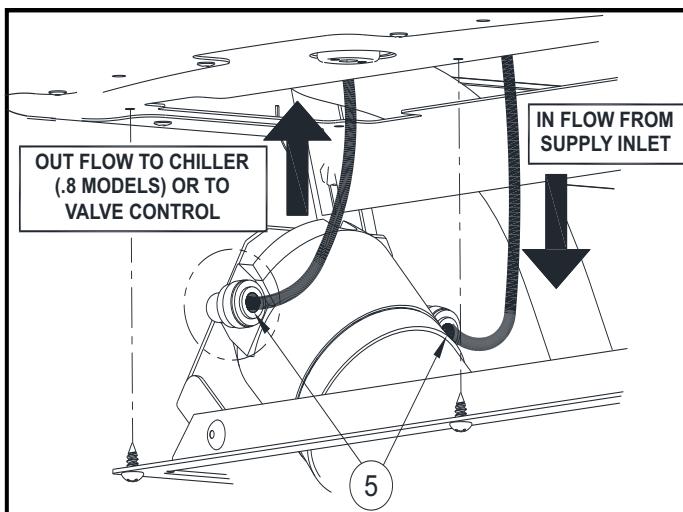
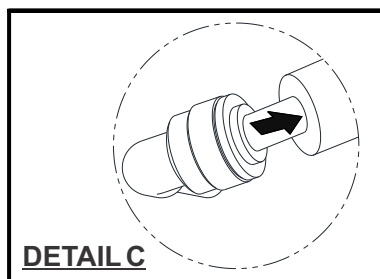

4 Install WF1EZ Filter Frame [6] by assembling the (6) #8 x 3/8" Long Stainless Steel Screws [7] provided.

Reinstall WF1EZ Filter Cartridge [8] back into cap by hand tightening the Filter Cartridge into place.

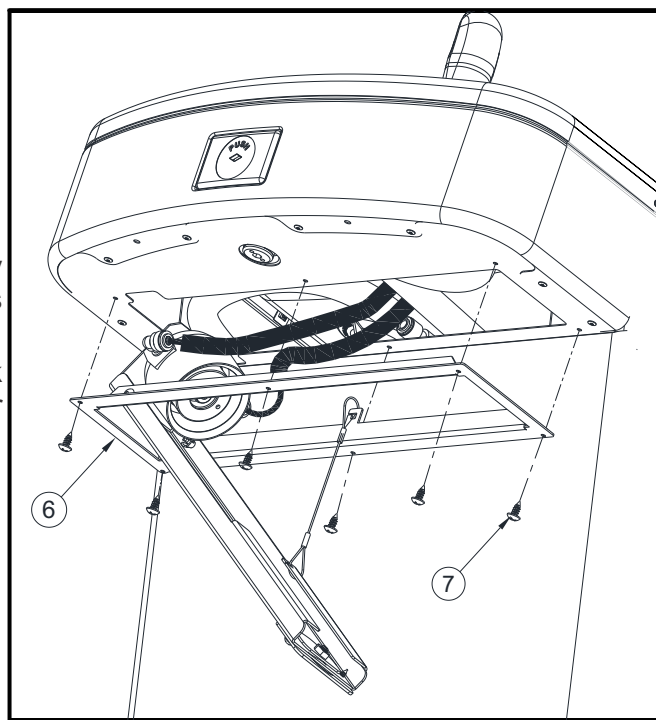
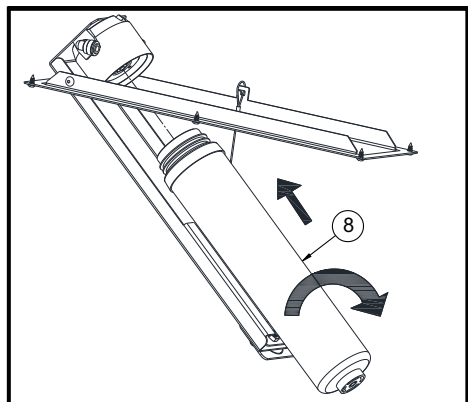

COMPLETING FILTER INSTALLATION

5 Lock **WF1EZ Filter Latch** [9] after installation is complete using the **Fixture Maintenance Tool** (**DETAIL D**).

NOTE: Fixture Maintenance Tool Required to Open and Close Latch. Provided with Drinking Fountain.

DETAIL D

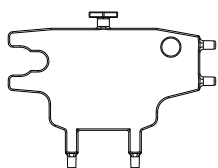

STANDARD PN: 7003-830-000

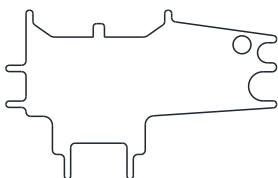

VR UNITS PN: 7003-194-199

Fixture Maintenance Tool

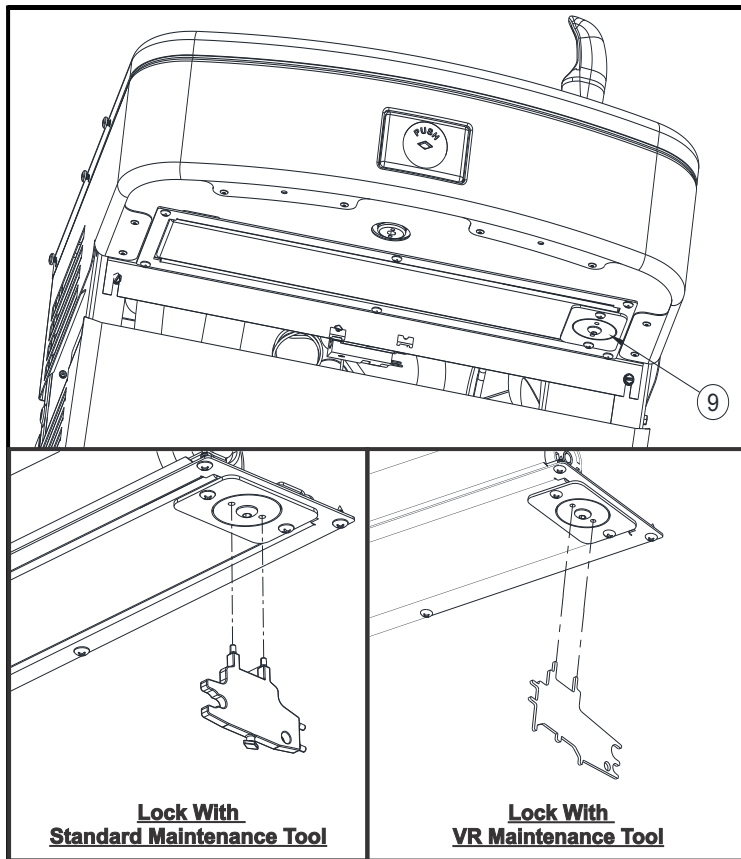

6 Turn Back On the Shut-Off Valve (**DETAIL A**).

When Needed Reassemble Housing Skirt Panel [11] by screwing back its 6 screws after installation is successful.

! IMPORTANT

Note: Check for any leaks after turning back on the Angle Stop Valve before continuing with further future installation.

7 Purge Water Filter for 10 minutes or 5 Gallons of continuous flow of running water.



REPLACEMENT FILTERS: Refer to Murdock® Accessory Model RWF1 for Replacement 1500-Gallon Filter (sold separately).

