



Boiler Stand Plumbing Kit

KIT # P-273 (FOR SL 40-399 G3 AND SL 26-260 G3)

Designed to work only with KIT # P-266

Instructions are intended for a Qualified Tradesman

Plumbing Assembly Instructions

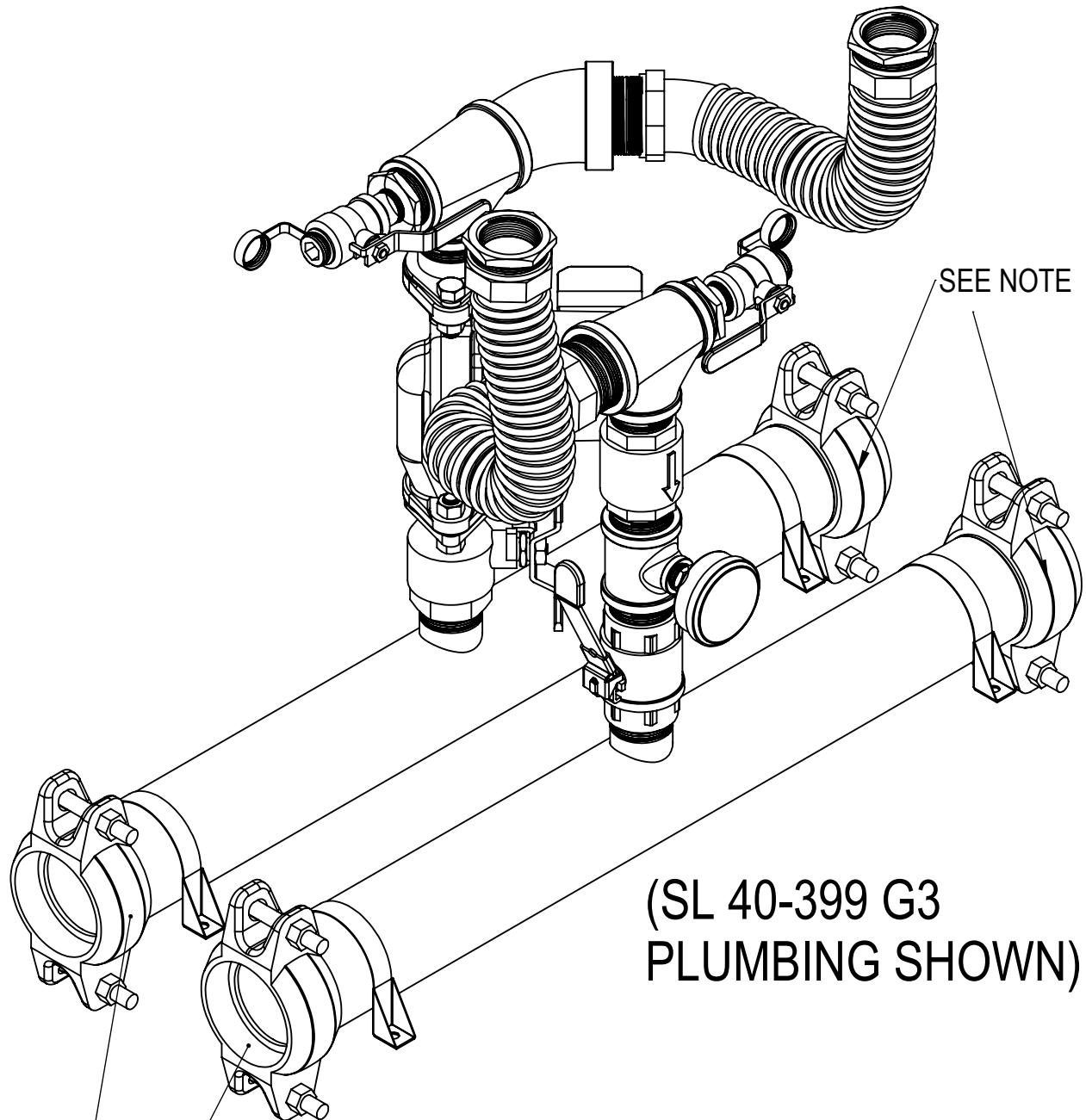

(SL 40-399 G3
PLUMBING SHOWN)

NOTE:
3" ROLL GROOVE COUPLERS
NOT PROVIDED BY IBC

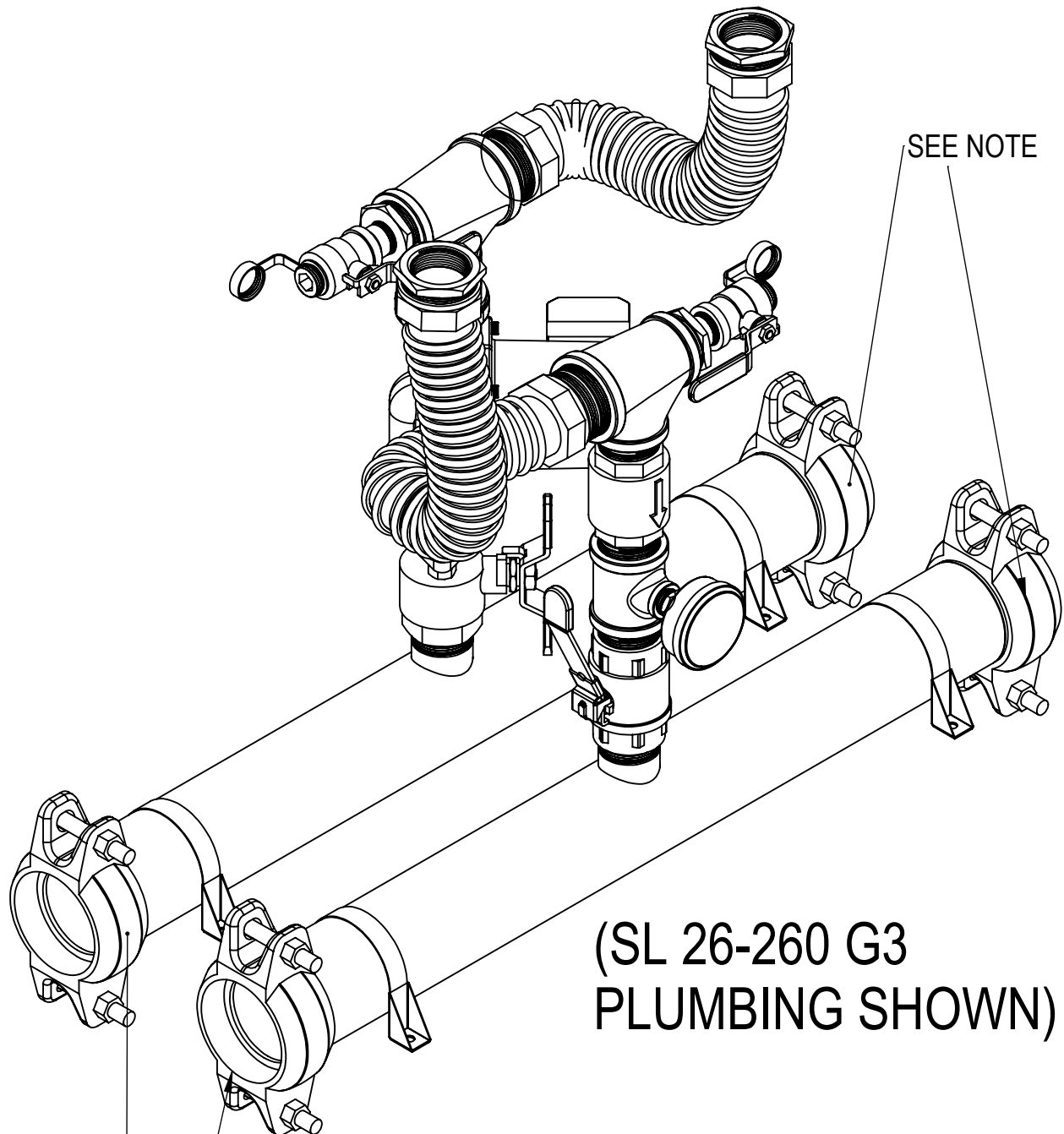

SEE NOTE

(SL 26-260 G3
PLUMBING SHOWN)

NOTE:
3" ROLL GROOVE COUPLERS
NOT PROVIDED BY IBC



INCLUDED IN KIT

KIT # P-273 is designed to work only with KIT # P-266

<u>Type</u>	<u>Description</u>	<u>QTY</u>	<u>IBC Part #</u>
Steel Welded Pipe	31.5" Steel Pipe w/ 1.5" Nipple	2	250-995
Pump	Circulator	1	180-151
Pump Flange	Pump Flange Set	1	180-154
Black Iron Fitting	1.5" x 1.5" x 0.5" Tee	1	190-182
Black Iron Fitting	2" x 1.5" x 1.5" Tee	2	190-183
Black Iron Fitting	1.5" to 0.75" Bushing	2	190-184
Black Iron Fitting	1.5" Close Nipple	4	190-075
Black Iron Fitting	2" Close Nipple	2	190-185
Black Iron Fitting	0.75" x 1.5" Nipple	2	190-084
Black Iron Fitting	0.5" to 0.25" Bushing	1	190-186
Black Iron Fitting	2" to 1.5" Bushing	2	190-187
Check Valve	1.5" Check Valve	1	180-244
Valve	1.5" Ball Valve	1	180-106
Valve	1.5" Ball Valve w/ Flange	1	180-063
Valve	3/4" NPT Garden Hose Bib Ball Valve	2	180-138
Hose	2" x 18" Stainless Corrugated Hose	2	190-189
Tridicator	Tridicator	1	180-019B
Sheet Metal	3" Pipe Clamps	4	250-900B
Black Iron Fitting	[Only Use on SL40-399 G3] 2", 45 Blk Str Elbw	1	190-188
Doc	Assembly Manual for KIT # P-273	1	120-310A
Hardware	Screw 8-32 x 0.75"	8	150-129
Hardware	Washer	8	150-077
Hardware	Wing Nut 8-32	8	150-269
Hardware	Spring Washer	8	150-026



STEP 1 - Pipe Installation

Center both pipes on the Boiler Stand and attach it into place by bending the 3" Pipe Clamps in-place. Also, install the Roll Groove Clamps at this time (not provided by IBC).

KIT # P-266
Boiler Stand:
SL 26-260 G3
Format

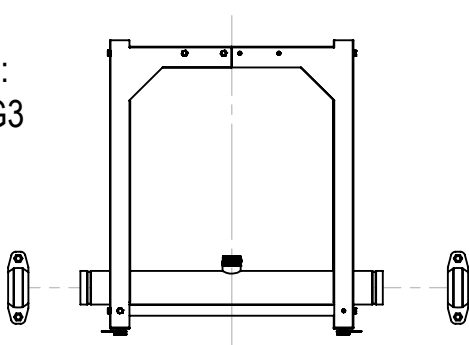

KIT # P-266
Boiler Stand:
SL 40-399 G3
Format

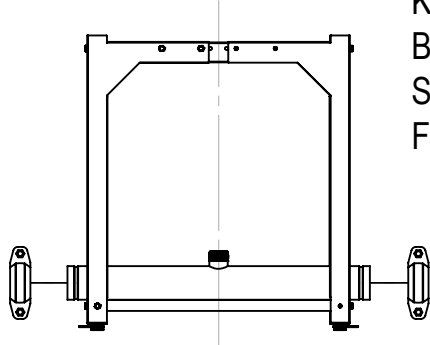

NOTE: 3" Pipe Clamps are bent around the SCH 10, 3"x 31.5" Steel Pipe, by hand.

3" Pipe Clamps
IBC Part#: 250-900B

KIT # P-266 Shown
(SL 26-260 G3 Format)

SEE NOTE

NOTE:
3" Roll Groove Clamp
(Not Supplied by IBC)

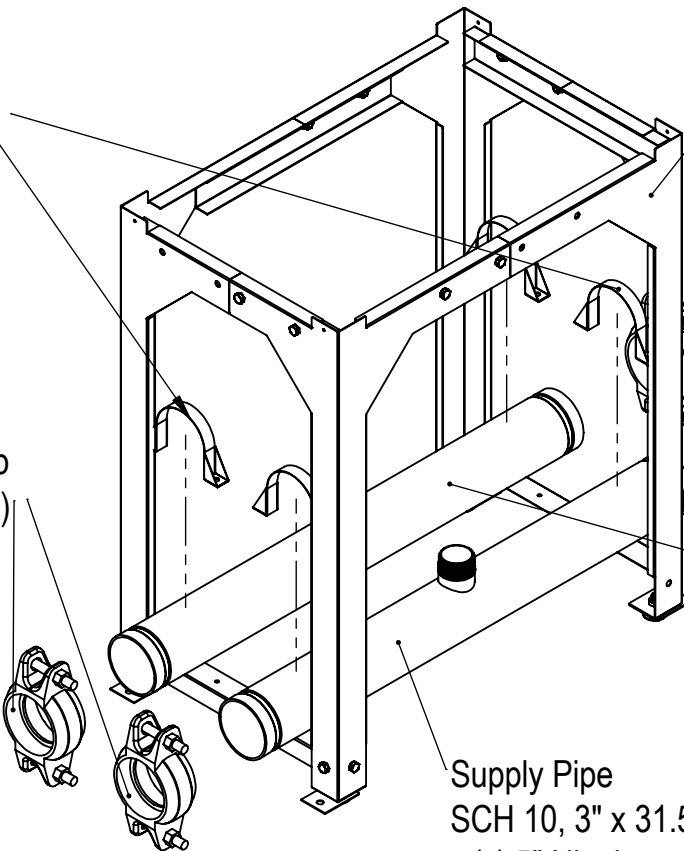

Return Pipe
SCH 10, 3" x 31.5"
Steel Pipe w/ 1.5" Nipple
IBC Part #: 250-995

Supply Pipe
SCH 10, 3" x 31.5" Steel Pipe
w/ 1.5" Nipple
IBC Part #: 250-995

Type	Description	QTY	IBC Part #
Sheet Metal	3" Pipe Clamps	4	250-900B
Steel Welded Pipe	31.5" Steel Pipe w/ 1.5" Nipple	2	250-995



Step 1 - Hardware Installation

Fasten the 3" Pipe Clamps down using the hardware provided in the kit, in the order shown below.

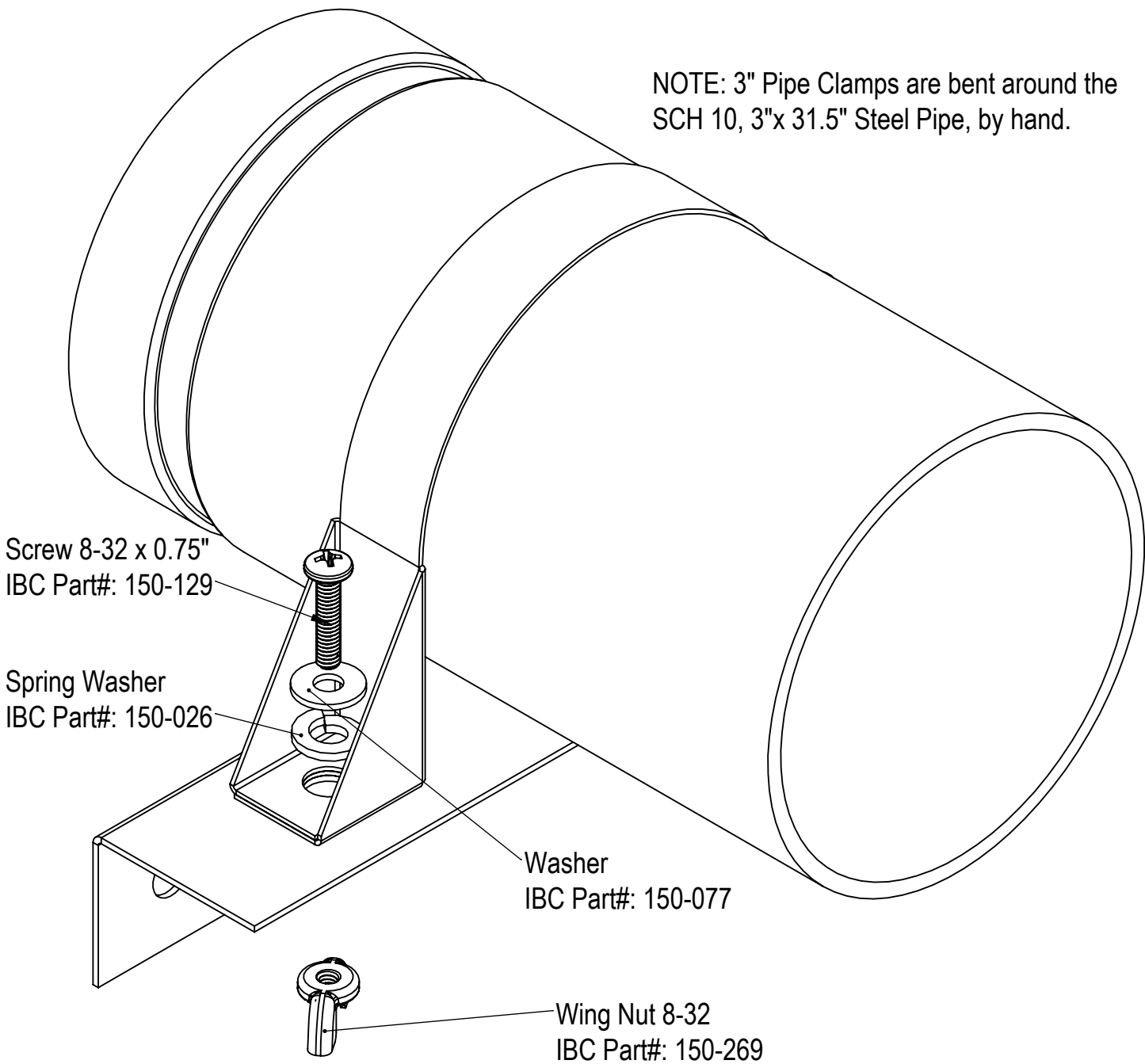

Type	Description	QTY	IBC Part #
Hardware	Screw 8-32 x 0.75"	8	150-129
Hardware	Washer	8	150-077
Hardware	Wing Nut 8-32	8	150-269
Hardware	Spring Washer	8	150-026



STEP 2 - Fittings Assembly

IMPORTANT: Orient the Check-Valve with the arrow pointing downwards.
Assemble the NPT fittings together with Teflon Tape and/or Thread Sealant.
-Assemble the NPT fittings in the same orientation as the diagram below.
-Assemble the Tridicator and 0.5" to 0.25" Bushing last.

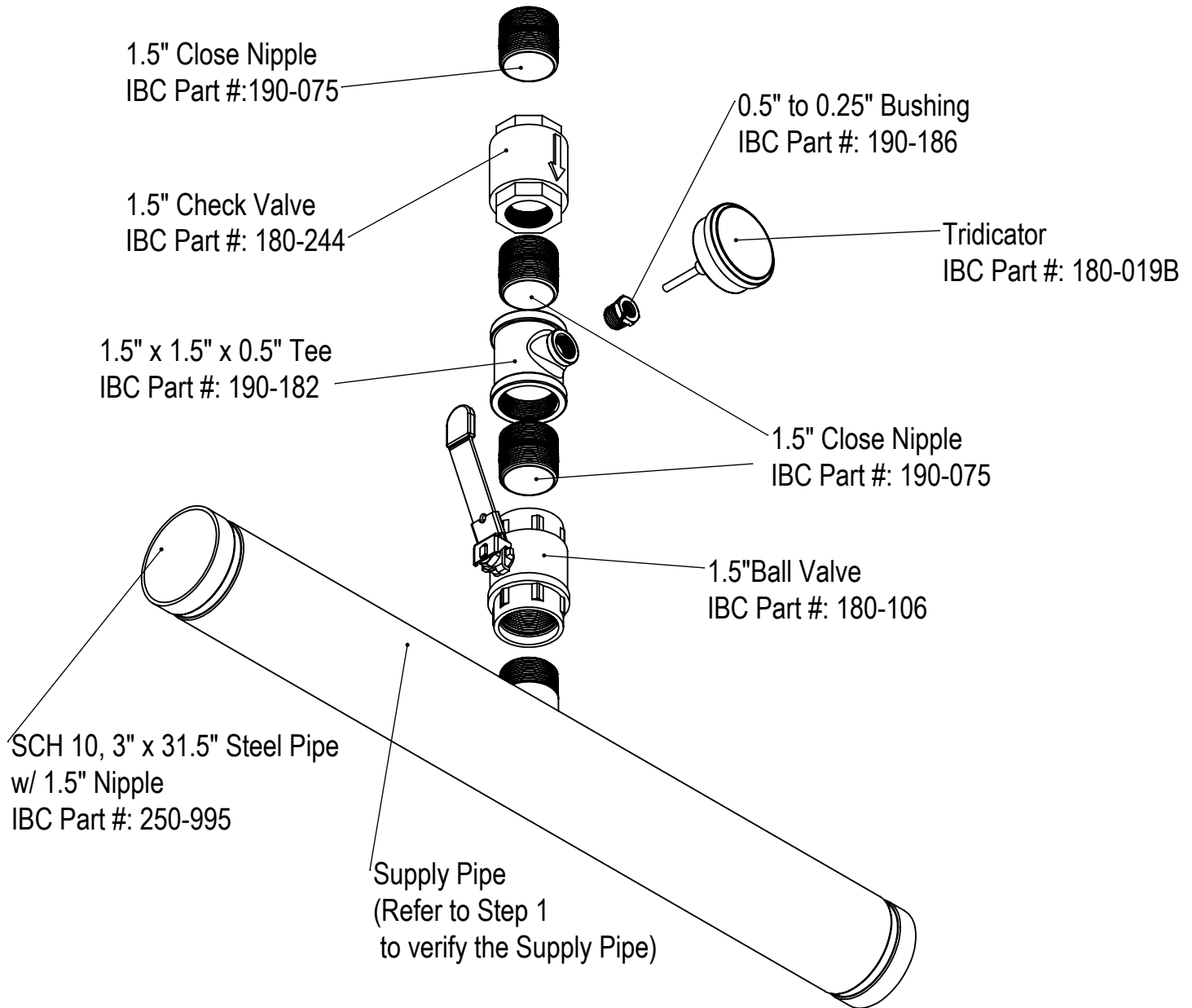

Type	Description	QTY	IBC Part #
Black Iron Fitting	1.5" x 1.5" x 0.5" Tee	1	190-182
Black Iron Fitting	0.5" to 0.25" Bushing	1	190-186
Tridicator	Tridicator	1	180-019B
Black Iron Fitting	1.5" Close Nipple	3	190-075
Valve	1.5" Ball Valve	1	180-106
Steel Welded Pipe	31.5" Steel Pipe w/ 1.5" Nipple	1	250-995
Check Valve	1.5" Check Valve	1	180-244



STEP 3 - Fittings Assembly

IMPORTANT: Assemble the NPT fittings together with Teflon Tape and/or Thread Sealant.

-Assemble the NPT fittings and ball valve in the same orientation as the diagram below.

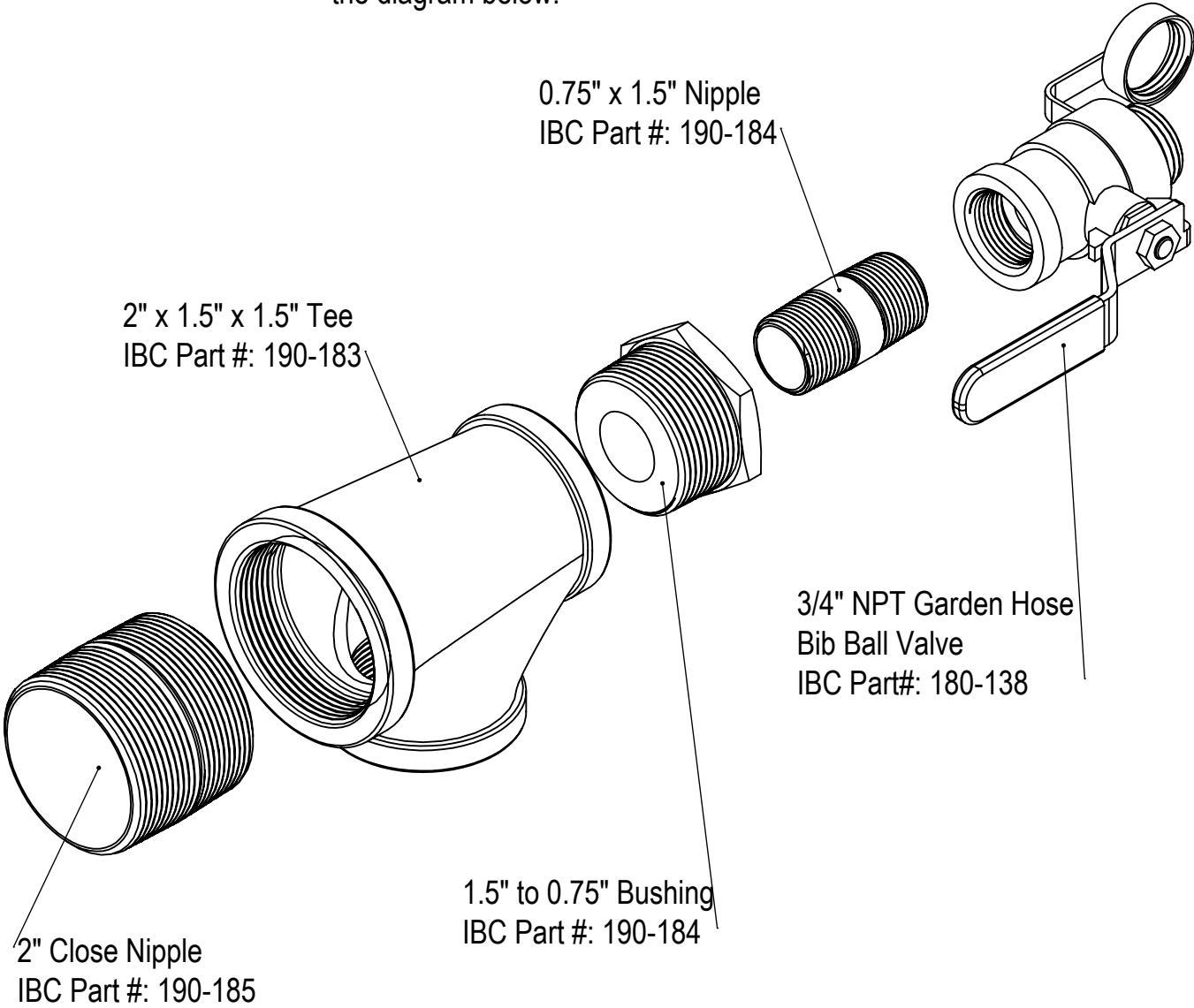

Type	Description	QTY	IBC Part #
Black Iron Fitting	2" Close Nipple	1	190-185
Black Iron Fitting	2" x 1.5" x 1.5" Tee	1	190-183
Black Iron Fitting	1.5" to 0.75" Bushing	1	190-184
Black Iron Fitting	0.75" x 1.5" Nipple	1	190-084
Valve	3/4" NPT Garden Hose Bib Ball Valve	1	180-138



STEP 4 - Boiler Supply/Return

IMPORTANT: Assemble the NPT fittings together with Teflon Tape and/or Thread Sealant.

-Use the diagrams below to locate the Boiler Supply and Boiler Return, and attach the assembly to the appropriate location.

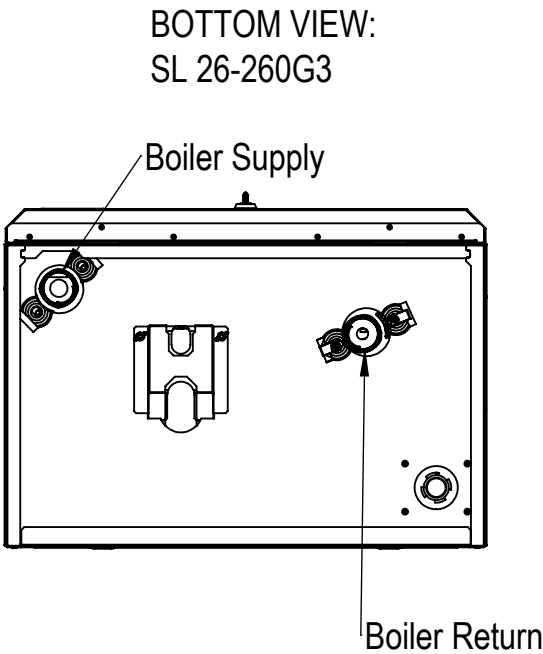
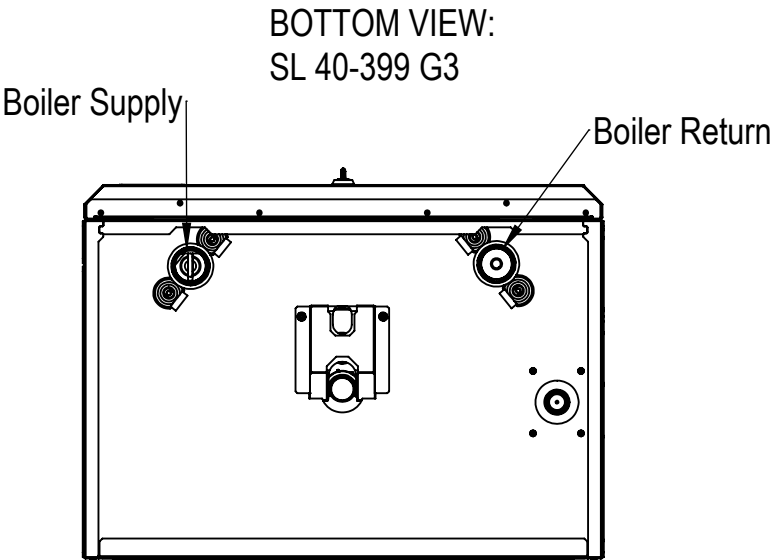

IMPORTANT:
Attach to Boiler Supply

2" to 1.5" Bushing
IBC Part #: 190-187

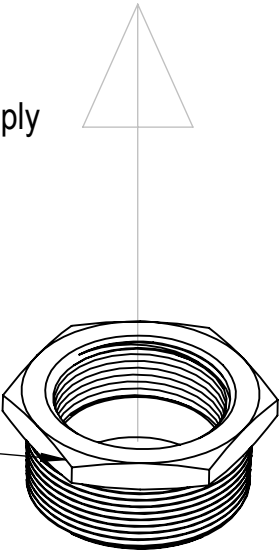

Type	Description	QTY	IBC Part #
Black Iron Fitting	2" to 1.5" Bushing	1	190-187



STEP 5 - Fittings Assembly

IMPORTANT: Assemble the NPT fittings together with Teflon Tape and/or Thread Sealant.

-Assemble the following pieces together in the orientation of the diagram below.

- Refer to Step 4 to find Boiler Supply
- Attached to Boiler Supply

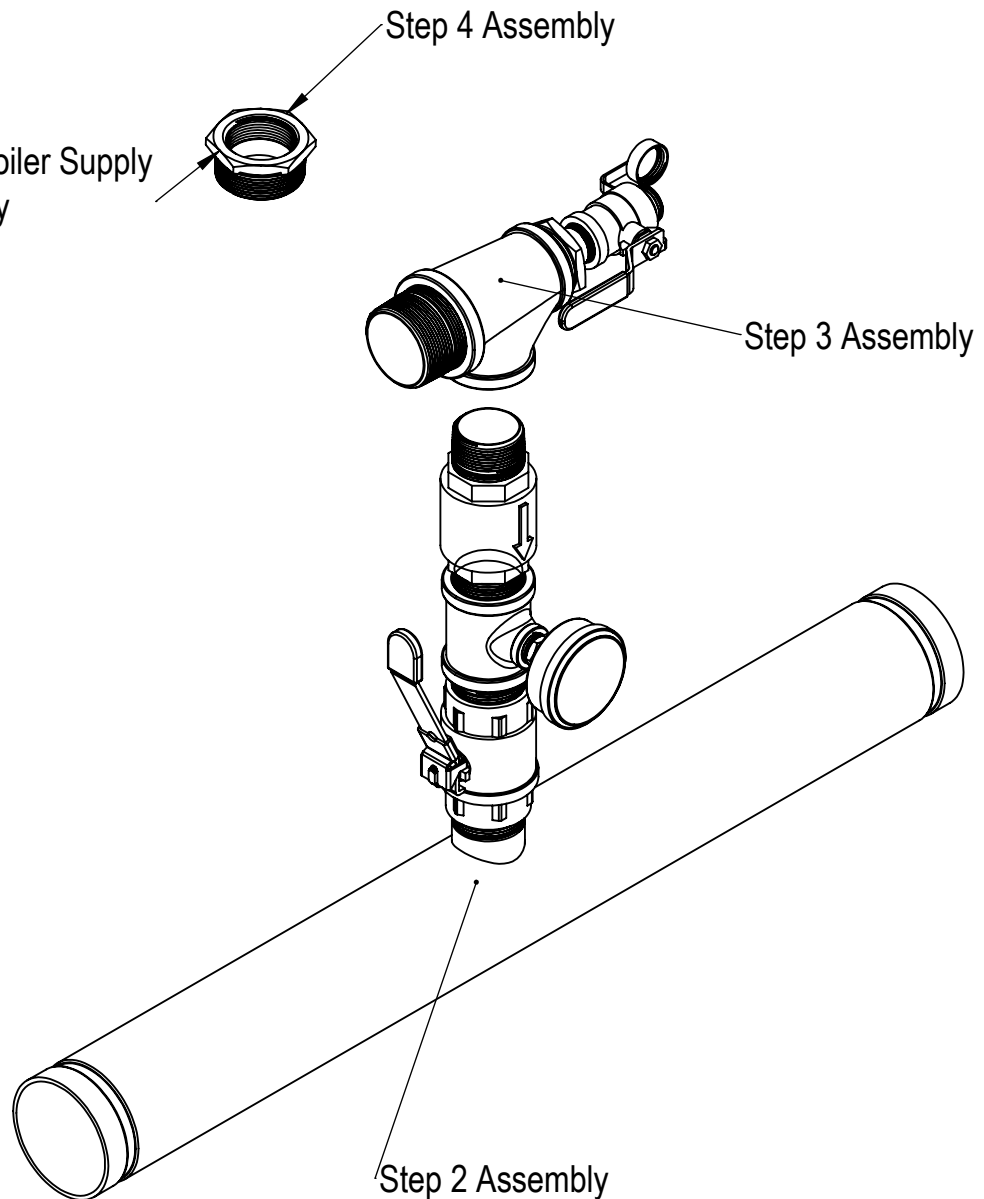



STEP 6 - Hose Assembly

IMPORTANT: DO NOT use Teflon Tape and/or Thread Sealant on ANY connection involving the 2" Corrugated Stainless Steel hose. The pipe seals on Rubber Gaskets and NOT on the NPT Threads. Assemble the rest of the pieces together with Teflon Tape and/or Thread Sealant.

- Bend Corrugated Hose into position and attach it to the Step 4 Assembly and Step 5 Assembly.

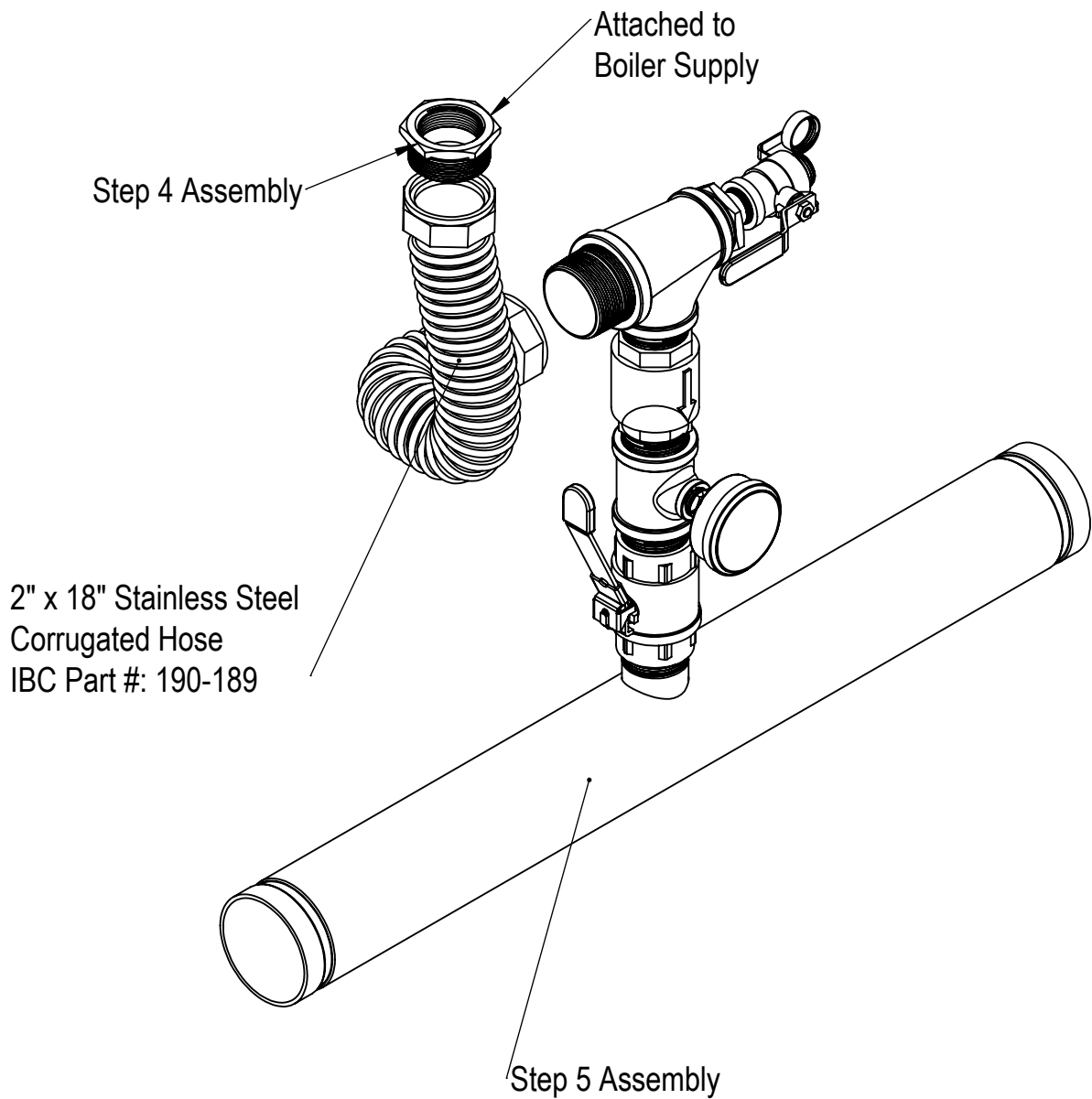

Type	Description	QTY	IBC Part #
Hose	2" x 18" Stainless Steel Corrugated Hose	1	190-189



STEP 7 - Pump Assembly

IMPORTANT: Install the pump with the arrow pointing up/away from the SCH 10, 3" x 31.5" Steel Pipe. Assemble the NPT fittings together with Teflon Tape and/or Thread Sealant.

- Turn the Ball Valve lever to the "Off" Position before installing, and install in the orientation below. This will make pump volute servicing easier.
- Install O-Ring provided in circulator box to seal the pump against the 1.5" Flanged Ball Valve
- Assemble the ball valve to the SCH 10, 3" x 31.5" Steel pipe first and in the same orientation as the diagram.
- Install the pump onto the ball valve last.

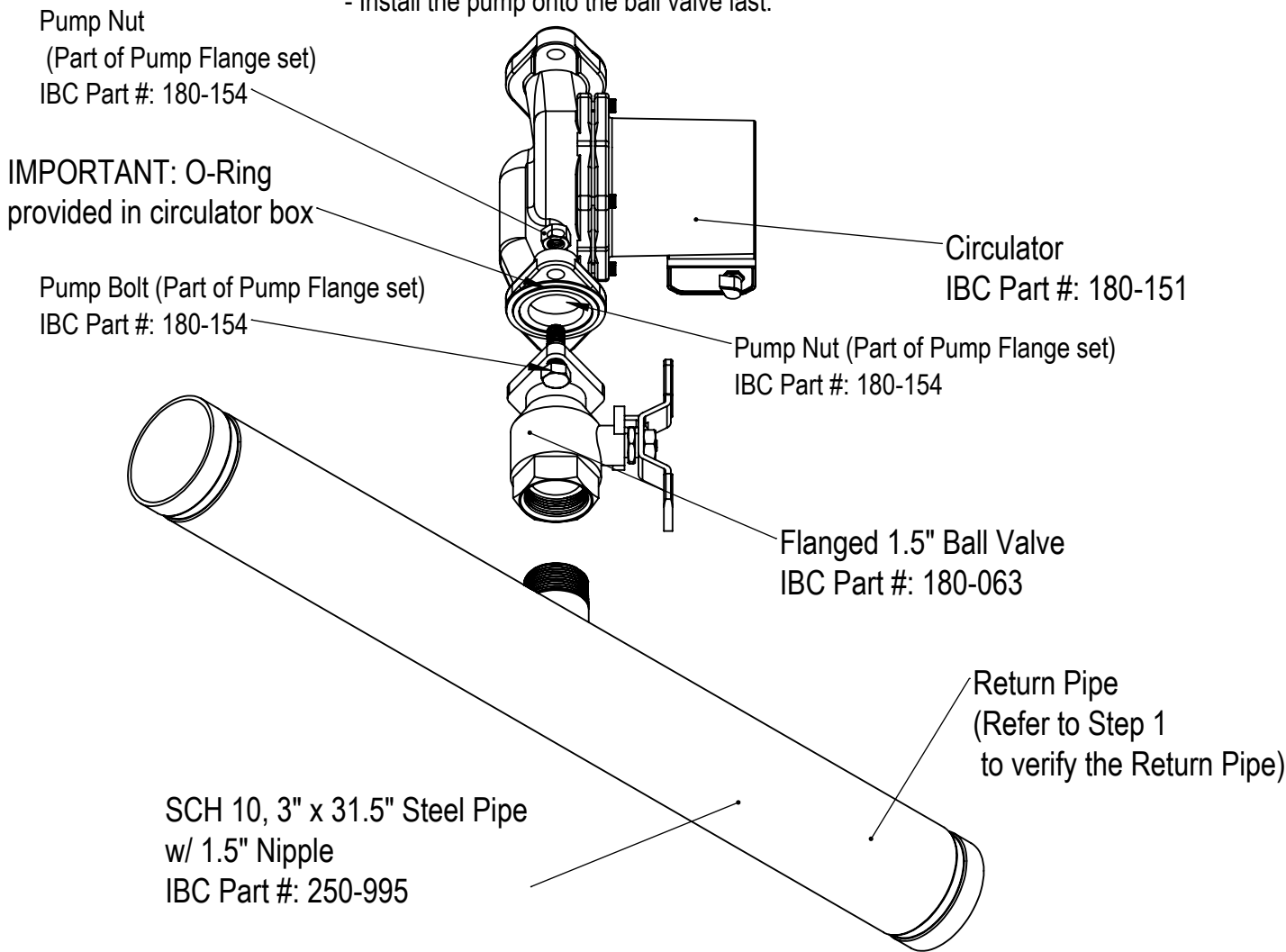

Type	Description	QTY	IBC Part #
Pump	Circulator	1	180-151
Steel Welded Pipe	31.5" Steel Pipe w/ 1.5" Nipple	1	250-995
Valve	1.5" Flanged Ball Valve	1	180-063
Pump Flange	Pump Flange Set	1	180-154



STEP 8 (FOR SL 40-399 G3)

IMPORTANT: Assemble the NPT fittings together with Teflon Tape and/or Thread Sealant.

- Assemble the pieces below in the correct orientation as the diagram below.

- Install the O-Ring provided to seal against the Pump Flange

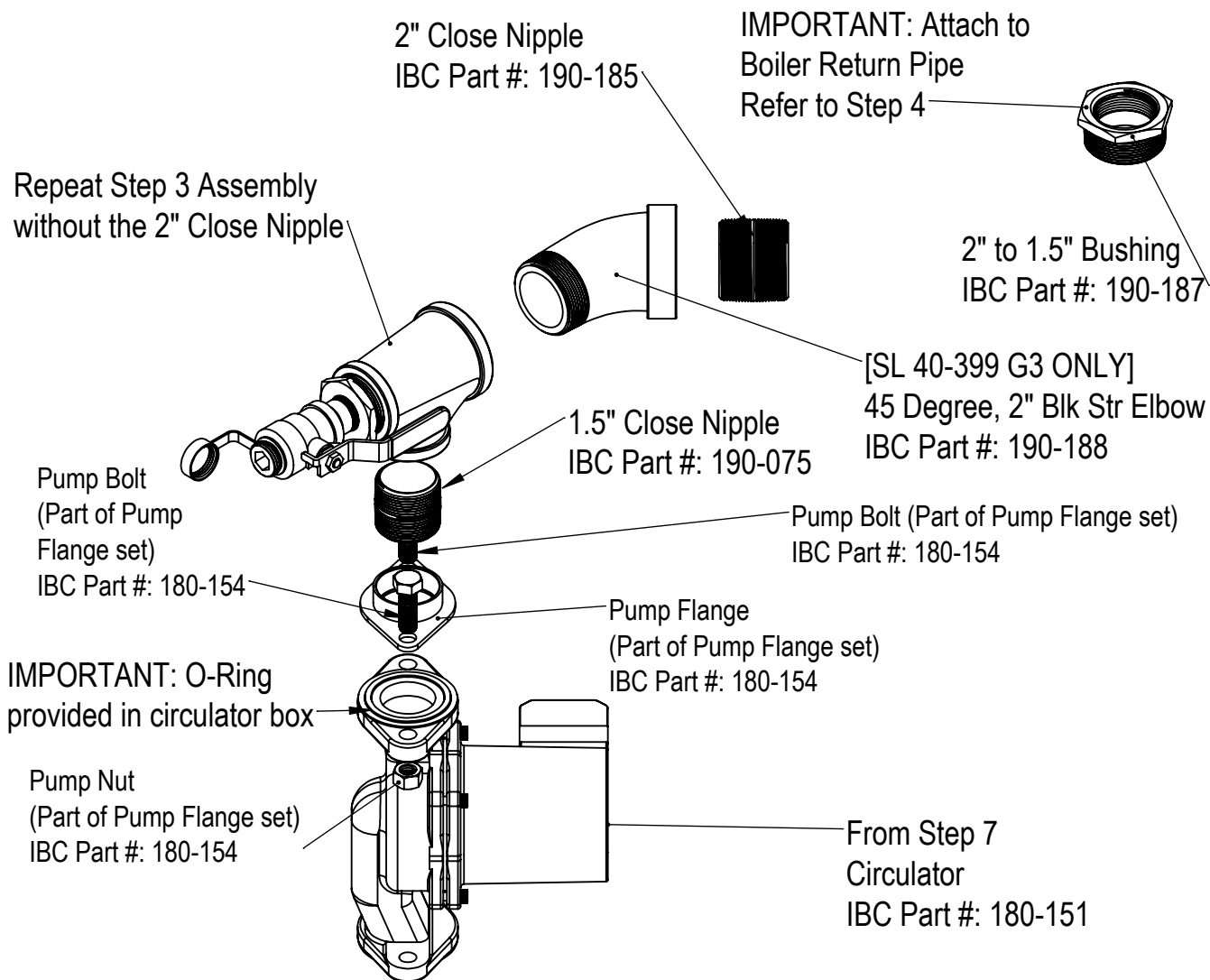

Type	Description	QTY	IBC Part #
Pump Flange	Pump Flange Set	1	180-154
Pump	Circulator	1	180-151
Black Iron Fitting	1.5" Close Nipple	1	190-075
Black Iron Fitting	[Only Use on SL40-399 G3] 2", 45 Blk Str Elbw	1	190-188
Black Iron Fitting	2" to 1.5" Bushing	1	190-187
Black Iron Fitting	2" Close Nipple	1	190-185



STEP 9 (FOR SL 40-399 G3)

IMPORTANT: DO NOT use Teflon Tape and/or Thread Sealant on ANY connection involving the 2" Corrugated Stainless pipe. The pipe seals on Rubber Gaskets and NOT on the NPT Threads.

- Assemble the 2" x 18" Stainless Steel Corrugated Hose last.
- Bend Corrugated Hose into position and attach it to the Step 4 assembly and the Step 5 Assembly.

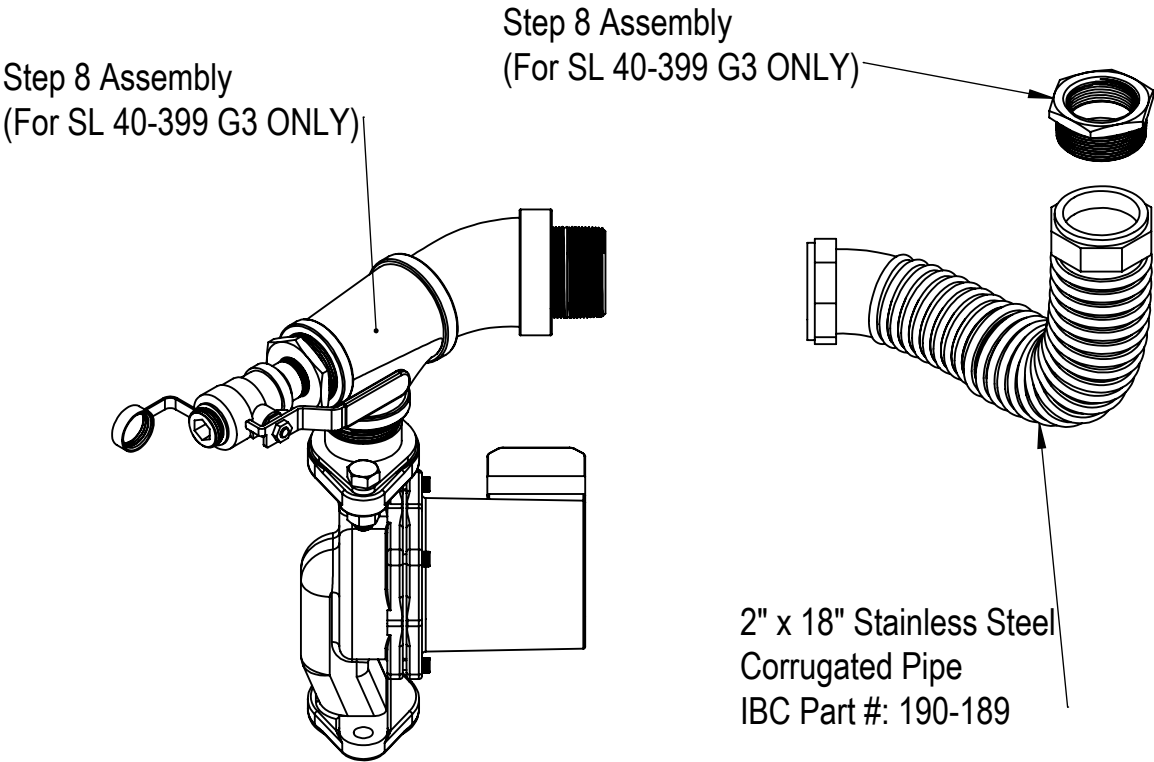

Type	Description	QTY	IBC Part #
Hose	2" x 18" Stainless Steel Corrugated Hose	1	190-189



- Assemble the pieces below in the correct orientation as the diagram below.

✓IMPORTANT: Attach to
Boiler Return
Refer to Step 4

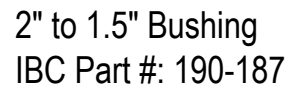

A detailed line drawing of a hand pump sprayer. It features a cylindrical body with a pump handle on the side. Attached to the front is a spray gun with a trigger and a nozzle. A hose connects the spray gun to the main body. A line points from the text 'Hand pump sprayer' to the main body of the device.

1.5" Close Nipple
IBC Part #: 190-075

Pump Bolt (Part of
Pump Flange set)
IBC Part #: 180-154

- Pump Flange (Part of Pump Flange Set)
 IBC Part #: 180-154

IMPORTANT: O-Ring
provided in circulator box

Pump Nut (Part of Pump Flange set)
IBC Part #: 180-154

From Step 7
Circulator
IBC Part #: 180-151

<u>Type</u>	<u>Description</u>	<u>QTY</u>	<u>IBC Part #</u>
Pump Flange	Pump Flange Set	1	180-154
Pump	Circulator	1	180-151
Black Iron Fitting	1.5" Close Nipple	1	190-075
Black Iron Fitting	2" to 1.5" Bushing	1	190-187



STEP 9 (FOR SL 26-260 G3)

IMPORTANT: DO NOT use Teflon Tape and/or Thread Sealant on ANY connection involving the 2" Corrugated Stainless pipe. The pipe seals on Rubber Gaskets and NOT on the NPT Threads.

- Assemble the 2" x 18" Stainless Steel Corrugated Hose last.
- Bend Corrugated Hose into position and attach it to the Step 4 Assembly and the Step 5 Assembly.

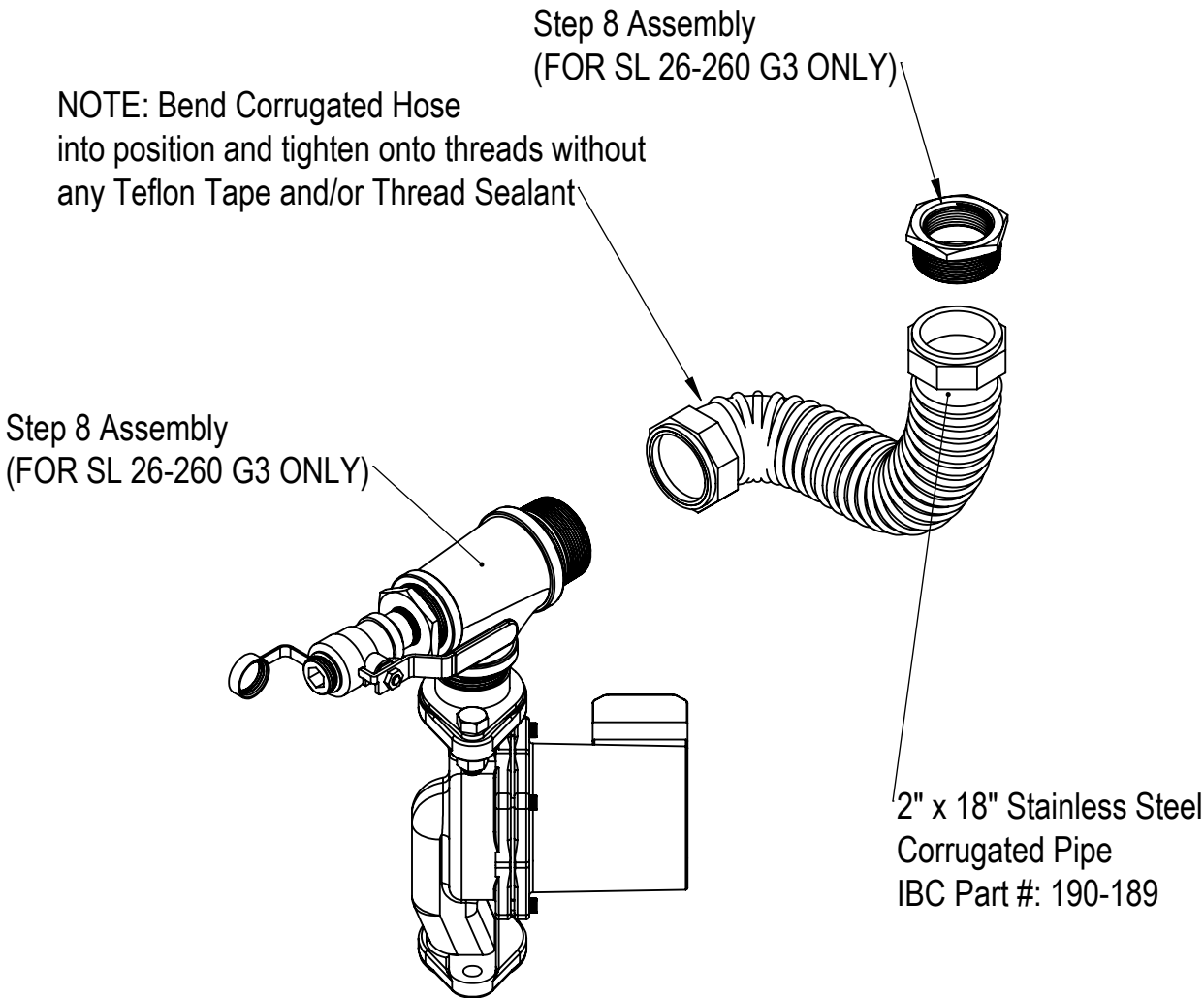

Type	Description	QTY	IBC Part #
Hose	2" x 18" Stainless Steel Corrugated Hose	1	190-189

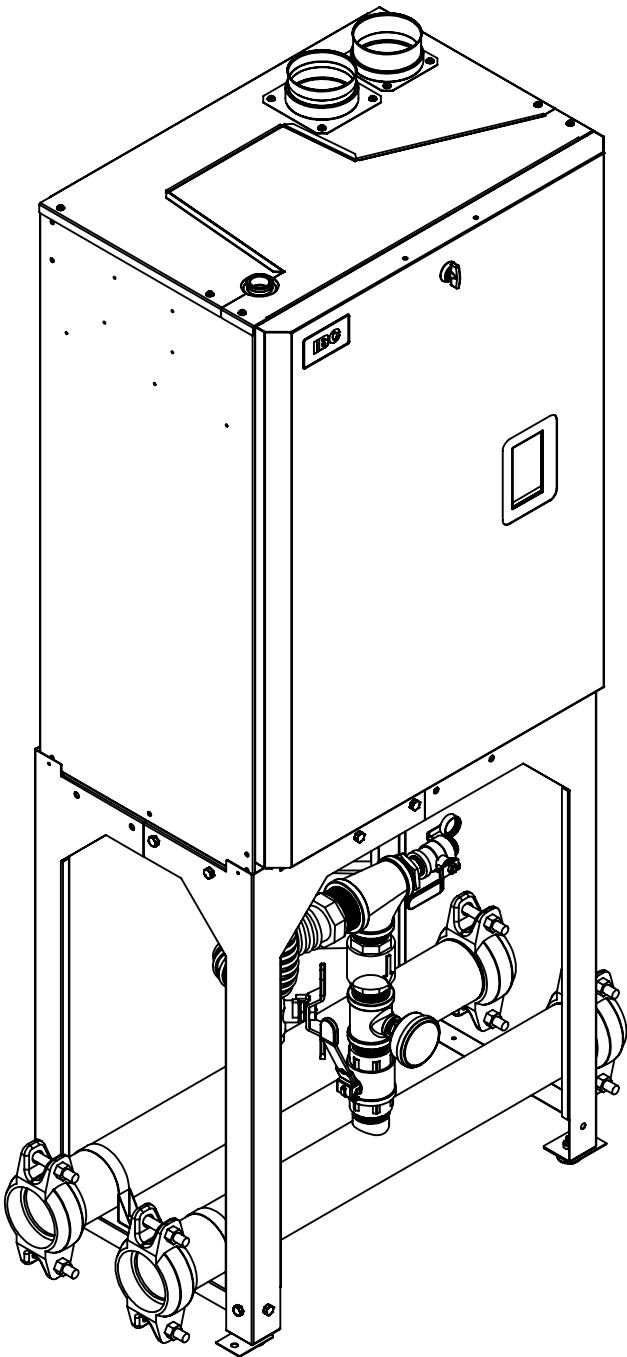

Finished KIT # P-273 and KIT # P-266
assembled with an SL 26-260 G3 Boiler.

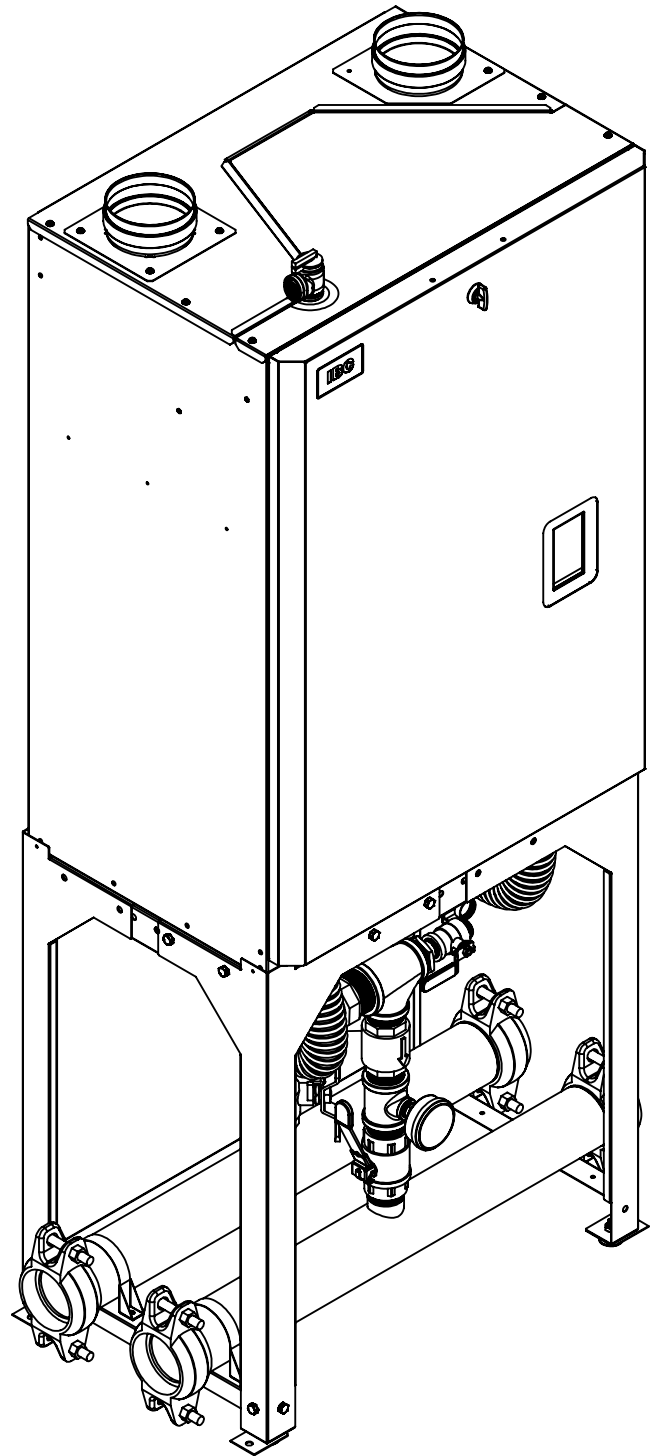

Finished KIT # P-273 and KIT # P-266 assembled
with an SL 40-399 G3 Boiler.